

# TNC Conn. Series

## Material & Finish

Body: Zinc Alloy Nickel Plated

Insulator: TEFLON

Center Contact : Phosphor Bronze , Gold Plating

Mounting Post: Bronze / Tin Plating

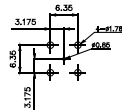
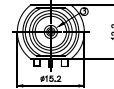
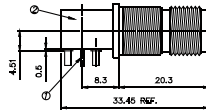
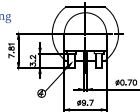

RECOMMENDED PC BOARD LAYOUT  
WITHOUT MOUNTING POSTS

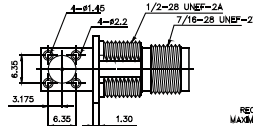

RECOMMENDED MOUNTING HOLE  
MAXIMUM PANEL THICKNESS: 5.5MM

**Part No.: TNCR001-F□GW-L**

5:50Ω 7:75Ω

## Material & Finish

Body: Zinc Alloy Nickel Plating

Insulator: DELRIN

Center Contact : Brass , Gold Plating

Mounting Post: Phosphor Bronze / Tin Plating

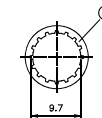
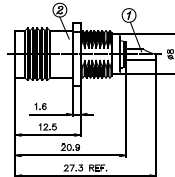
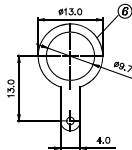

WASHER

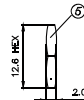
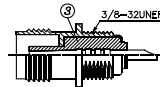

HEX NUT

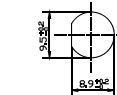

RECOMMENDED MOUNTING HOLE  
MAXIMUM PANEL THICKNESS: 5.5MM

**Part No.: TNCS001-F□GW-L**

5:50Ω 7:75Ω