

Specifications

Current Rating: 0.5A AC,DC

Voltage Rating: 30V AC,DC

Temperature Range: -25°C to +85°C

Contact Resistance: 20mΩ Max

Insulation Resistance: 100MΩ Min

Withstanding Voltage: 200V AC/minute

Terminal: Phosphor Bronze / Tin Plated

Material: Nylon 46, UL94V-0

Part No.	Dimensions	
	A	B
0800IDC-02TW-U	0.80	3.20
0800IDC-03TW-U	1.60	4.00
0800IDC-04TW-U	2.40	4.80
0800IDC-05TW-U	3.20	5.60
0800IDC-06TW-U	4.00	6.40
0800IDC-07TW-U	4.80	7.20
0800IDC-08TW-U	5.60	8.00
0800IDC-10TW-U	7.20	9.60
0800IDC-12TW-U	8.80	11.20
0800IDC-14TW-U	10.40	12.80
0800IDC-15TW-U	11.20	13.60
0800IDC-16TW-U	12.00	14.40
0800IDC-17TW-U	12.80	15.20
0800IDC-20TW-U	15.20	17.60

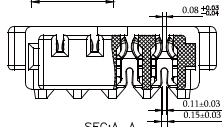
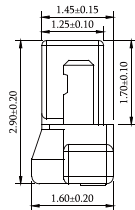
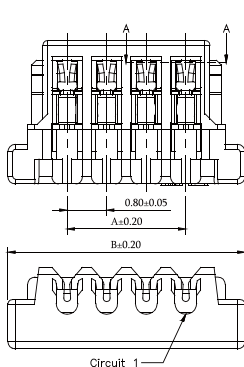

SEC:A-A

Part No.:0800IDC-XXTW-U

1:With Ear
2:W/O Ear