

Specifications

Current Rating: 2.4A AC,DC
 Voltage Rating: 250V AC,DC
 Temperature Range: -40°C to +105°C
 Contact Resistance: 15mΩ Max.
 Insulation Resistance: 1000MΩ Min.
 Withstanding Voltage: 750V AC/minute
 Pin Material: Tin Plating
 Material:LCP,UL94V-0

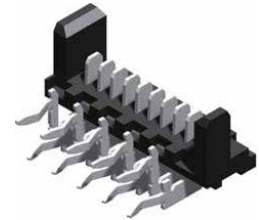

| Part No. | Dimensions | |
|--------------|------------|-------|
| | A | B |
| 1271R-04TB-U | 8.86 | 3.81 |
| 1271R-06TB-U | 11.40 | 6.35 |
| 1271R-08TB-U | 13.94 | 8.89 |
| 1271R-10TB-U | 16.48 | 11.43 |
| 1271R-12TB-U | 19.02 | 13.97 |
| 1271R-14TB-U | 21.56 | 16.51 |
| 1271R-16TB-U | 24.10 | 19.05 |
| 1271R-18TB-U | 26.64 | 21.59 |
| 1271R-20TB-U | 29.18 | 24.13 |
| 1271R-22TB-U | 31.72 | 26.67 |
| 1271R-24TB-U | 34.26 | 29.21 |
| 1271R-26TB-U | 36.80 | 31.75 |

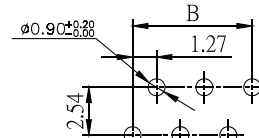
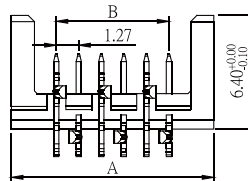
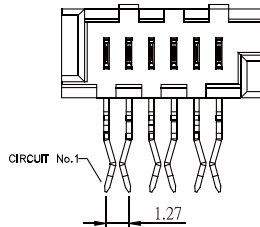

P.C.B. LAYOUT

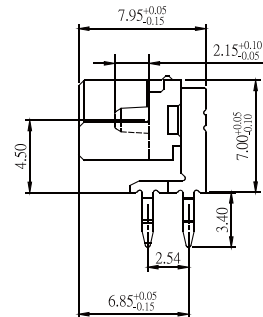

Part No.:1271R-XXTB-U