

Specifications

Current Rating: 3A AC,DC
 Voltage Rating: 250V AC,DC
 Temperature Range: -25°C to +85°C
 Contact Resistance: 10mΩ Max
 Insulation Resistance: 1000MΩ Min
 Withstanding Voltage: 800V AC/minute
 Material: Nylon 66,UL94V-0
 *Mates With 2004-T-B or 2004-T-C

Part No.	Dimensions	
	A	B
2004H-202W2-L	2,00	5,90
2004H-203W2-L	4,00	7,90
2004H-204W2-L	6,00	9,90
2004H-205W2-L	8,00	11,90
2004H-206W2-L	20,00	13,90
2004H-207W2-L	22,00	15,90
2004H-208W2-L	24,00	17,90
2004H-209W2-L	26,00	19,90
2004H-220W2-L	28,00	21,90
2004H-222W2-L	20,00	23,90
2004H-222W2-L	22,00	25,90
2004H-223W2-L	24,00	27,90
2004H-224W2-L	26,00	29,90
2004H-225W2-L	28,00	31,90
2004H-226W2-L	30,00	33,90
2004H-227W2-L	32,00	35,90
2004H-228W2-L	34,00	37,90
2004H-229W2-L	36,00	39,90
2004H-220W2-L	38,00	41,90
2004H-221W2-L	40,00	43,90
2004H-222W2-L	42,00	45,90

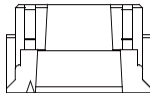

2X02~2X06P

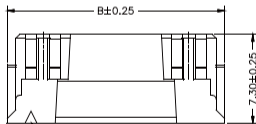
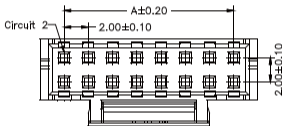

Circuit 1 2X07~2X22P

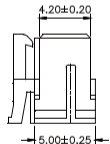
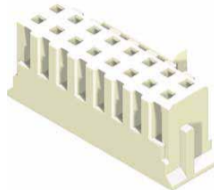

Part No.:2004H-2XXW2-L