

Specifications

Current Rating: 4A AC,DC
Voltage Rating: 125V AC,DC
Temperature Range: -25°C to +85°C
Contact Resistance: 10mΩ Max
Insulation Resistance: 1000MΩ Min
Withstanding Voltage: 1000V AC/minute
Terminal: Brass / Tin Plated
Material:Nylon 66,UL94V-0

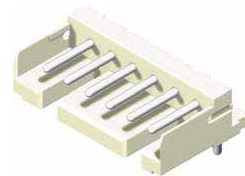

Part No.	Dimensions	
	A	B
2006R-02TW-L	2.00	5.96
2006R-03TW-L	4.00	7.96
2006R-04TW-L	6.00	9.96
2006R-05TW-L	8.00	11.96
2006R-06TW-L	10.00	13.96
2006R-07TW-L	12.00	15.96
2006R-08TW-L	14.00	17.96
2006R-09TW-L	16.00	19.96
2006R-10TW-L	18.00	21.96
2006R-11TW-L	20.00	23.96
2006R-12TW-L	22.00	25.96
2006R-13TW-L	24.00	27.96
2006R-14TW-L	26.00	29.96
2006R-15TW-L	28.00	31.96

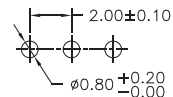
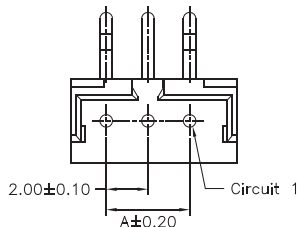

P.C.B LAYOUT

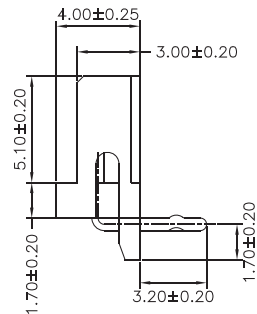
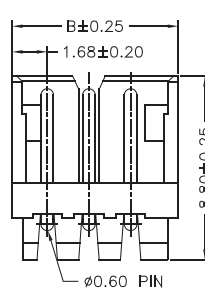

Part No.:2006R-XXTW-L