

Specifications

Current Rating: 3A AC,DC
 Voltage Rating: 250V AC,DC
 Temperature Range: -25°C to +85°C
 Contact Resistance: 20m Ω Max
 Insulation Resistance: 1000MΩ Min
 Withstanding Voltage: 800V AC/minute
 Terminal: Brass / Tin Plated
 Material: PBT, UL94V-0

Part No.	Dimensions	
	A	B
2013S-102TW-L	2.00	6.00
2013S-103TW-L	4.00	8.00
2013S-104TW-L	6.00	10.00
2013S-105TW-L	8.00	12.00
2013S-106TW-L	10.00	14.00
2013S-107TW-L	12.00	16.00
2013S-108TW-L	14.00	18.00
2013S-109TW-L	16.00	20.00
2013S-110TW-L	18.00	22.00
2013S-111TW-L	20.00	24.00
2013S-112TW-L	22.00	26.00
2013S-113TW-L	24.00	28.00
2013S-114TW-L	26.00	30.00
2013S-115TW-L	28.00	32.00

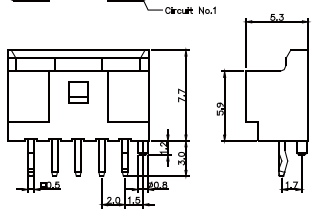
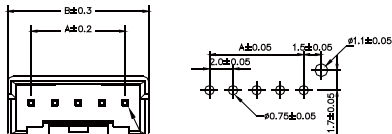

02P~09P

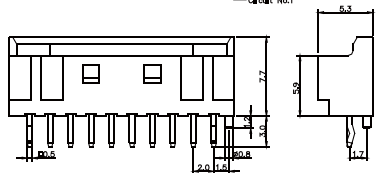
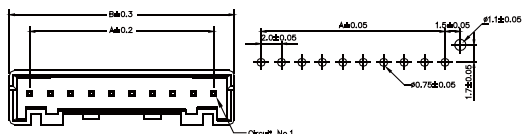

10P~15P

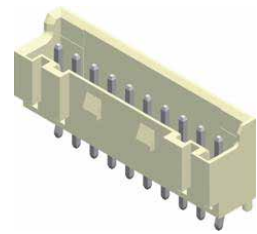

Part No.:2013S-XXTW-L