

# Machine Pin Header IC Type 1.778mm

## Specifications

Current Rate: 3 AMP  
 Insulation Resistance:  $\geq 1000M\Omega$  at  $V=100V$ .  
 Contact Resistance:  $\leq 10m\Omega$ /Contact.  
 Dielectric Voltage: 60V AC for one minute  
 Operation Temperature:  $-40^{\circ}C$  to  $+105^{\circ}C$

## Material

Insulator: Polyester, UL 94V-0  
 ©Standard: PPS  
 Terminal: Copper Alloy  
 Plated: Selective & Gold Plated

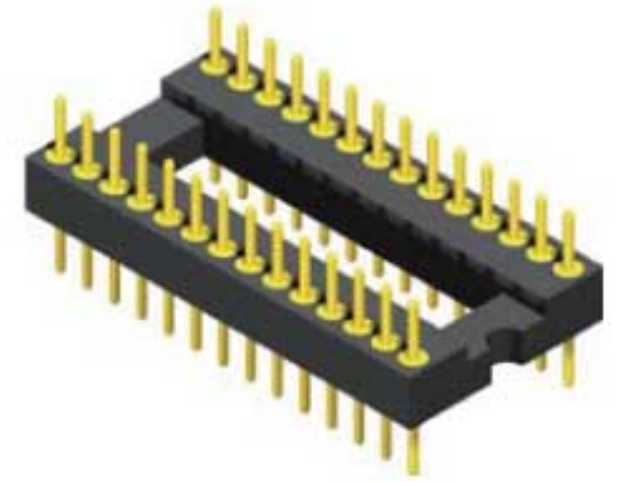
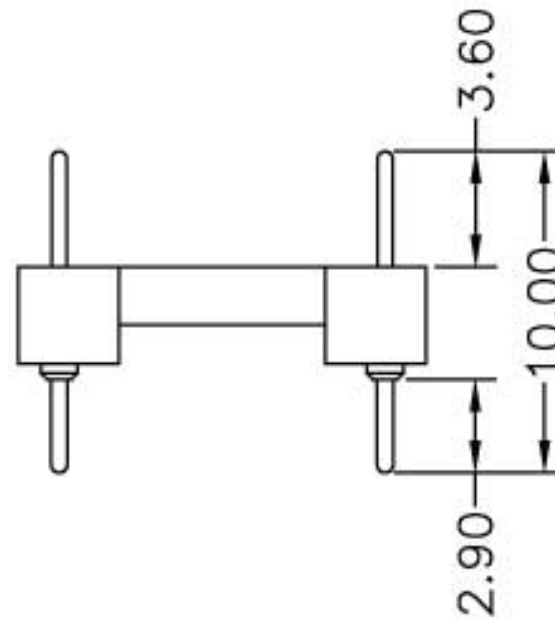
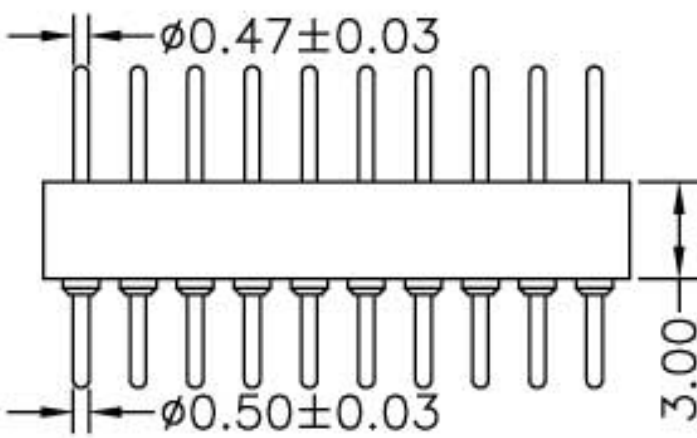
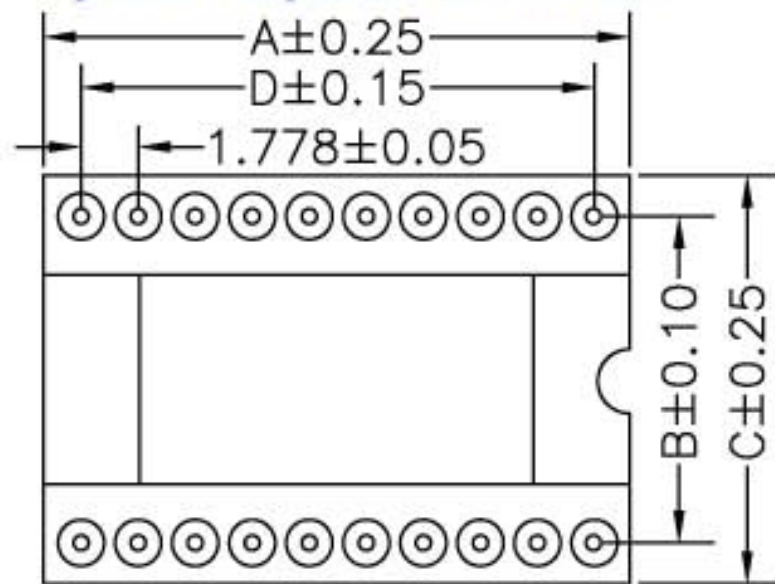

No. of Contacts	Dim. A	Dim. B	Dim. C	Dim. D	
24	21.80	10.16	12.70	19.558	0.4"
28	25.20	10.16	12.70	23.114	
30	27.17	10.16	12.70	24.892	
32	28.948	10.16	12.70	26.670	
48	43.172	10.16	12.70	40.894	
No. of Contacts	Dim. A	Dim. B	Dim. C	Dim. D	
20	18.28	15.24	17.64	16.002	0.6"
24	21.836	15.24	17.64	19.558	
28	25.392	15.24	17.64	23.114	
40	35.80	15.24	17.64	33.782	
42	37.70	15.24	17.64	35.560	
48	43.10	15.24	17.64	40.894	
52	46.70	15.24	17.64	44.450	
56	50.20	15.24	17.64	48.006	
No. of Contacts	Dim. A	Dim. B	Dim. C	Dim. D	
64	57.30	15.24	17.64	55.118	0.7"
68	60.90	15.24	17.64	58.674	
No. of Contacts	Dim. A	Dim. B	Dim. C	Dim. D	
64	57.30	19.05	21.45	55.118	

# Machine Pin Socket IC Type 1.778mm

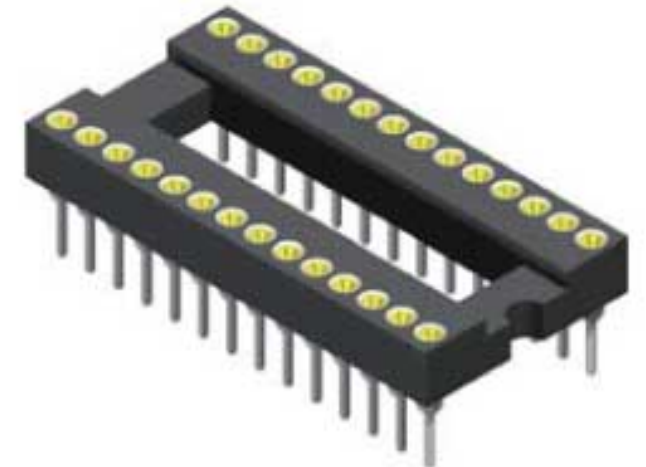
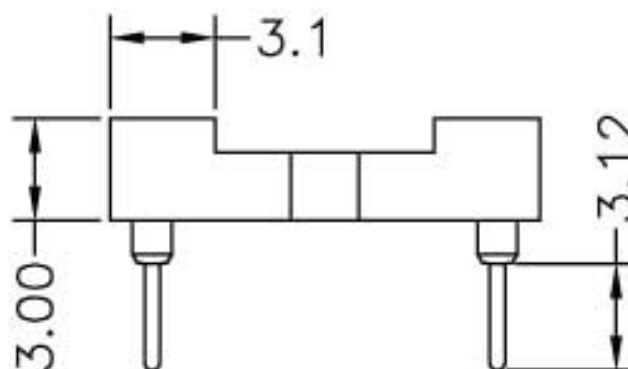
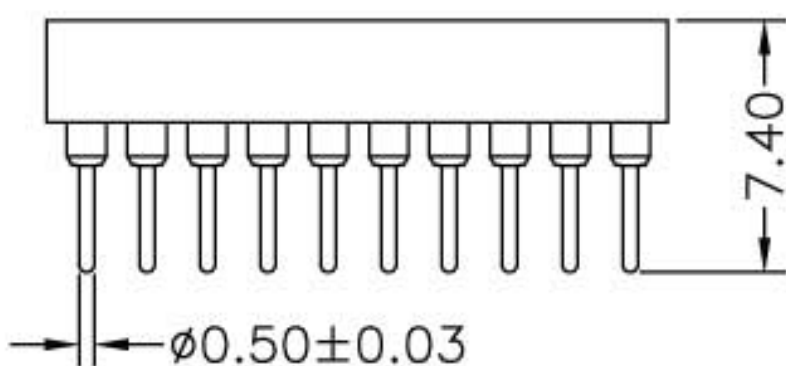
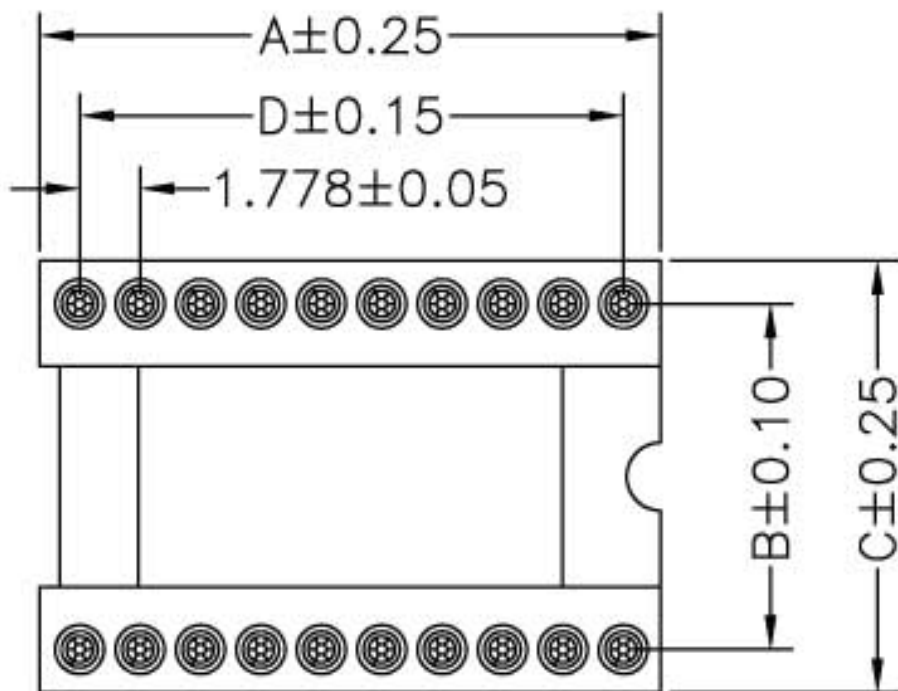

No. of Contacts	Dim. A	Dim. B	Dim. C	Dim. D	
24	21.80	10.16	12.70	19.558	0.4"
28	25.20	10.16	12.70	23.114	
30	27.17	10.16	12.70	24.892	
32	28.948	10.16	12.70	26.670	
48	43.172	10.16	12.70	40.894	
No. of Contacts	Dim. A	Dim. B	Dim. C	Dim. D	
20	18.28	15.24	17.64	16.002	0.6"
24	21.836	15.24	17.64	19.558	
28	25.392	15.24	17.64	23.114	
40	35.80	15.24	17.64	33.782	
42	37.70	15.24	17.64	35.560	
48	43.10	15.24	17.64	40.894	
52	46.70	15.24	17.64	44.450	
56	50.20	15.24	17.64	48.006	
No. of Contacts	Dim. A	Dim. B	Dim. C	Dim. D	
64	57.30	15.24	17.64	55.118	0.7"
68	60.90	15.24	17.64	58.674	
No. of Contacts	Dim. A	Dim. B	Dim. C	Dim. D	
64	57.30	19.05	21.45	55.118	