

Modular Jack Shielded SMT Type Single Port H=11.35 W=13.40

Material & Finish

Housing: Glass Fiber, LCP, UL 94V-0, Black
 Contact :0.35mm Thickness Phosphor Bronze,
 Gold Plated Over Nickel on Contact Area.

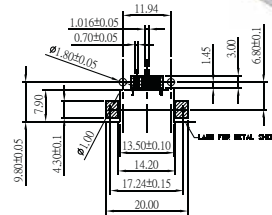
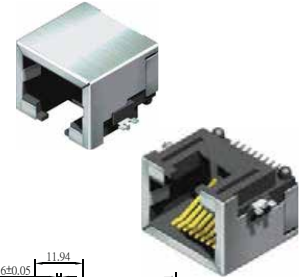
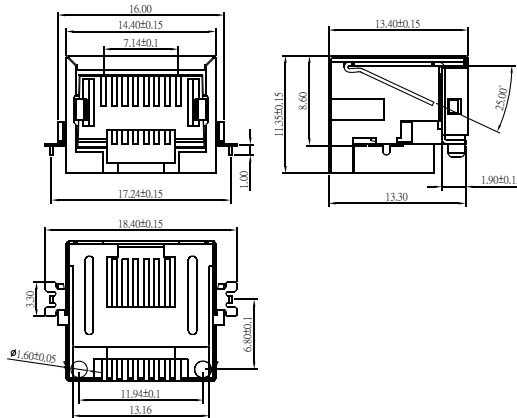

Order Information

M R J E I M - 8 P 8 C - X X - U

