

# Modular Jack Shielded Side Entry SMT Type H=13.6 W=18.5

## Material&Finish

Housing: P.B.T, UL 94V-0, Black  
 Contact :0.35x0.42mm Thickness Phosphor Bronze,  
 Gold Plated Over Nickel on Contact Area,  
 Tin Plated Over Nickel on Solder Area.  
 Shield:Copper Alloy With Nickel Plated.

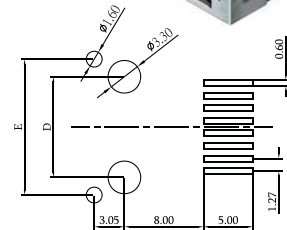
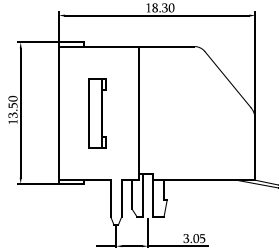
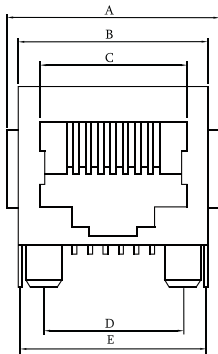
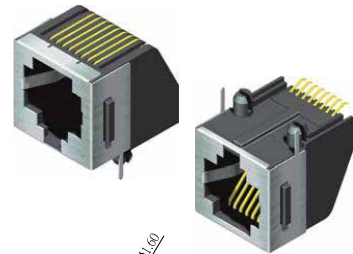

Recommended PCB Layout  
 (PCB TOLERANCE  $\pm 0.05$ )

Positions	Contacts	A	B	C	D	E
6P	6C	15.75	13.80	10.00	10.16	13.70
8P	8C	17.45	16.00	11.95	11.43	15.65

## Order Information

